

CLOQUET PARKS COMMISSION AGENDA

Web Meeting
Monday, April 5, 2021 4:30 p.m.

Please join my meeting from your computer, tablet or smartphone.
<https://www.gotomeet.me/cpeterson7>

You can also dial in using your phone.
United States: [+1 \(872\) 240-3212](tel:+18722403212)

Access Code: 141-668-741

ACTION TAKEN

1. Call to Order.

2. Approval of Minutes.

- a. February 1, 2021, Regular Commission Meeting.
(Additions, deletions, or corrections)

3. Announcements, Agenda Adjustments, Correspondence, and Other Comments.

4. Information and Reports.

a. Commissioners Update/Other.

- Public Comments.
Please give your name, and address. Visitors may share concerns on any issue, which is not already on the agenda. Each person will have 3 minutes to speak. The Chair reserves the right to limit an individual's presentation if it becomes redundant, repetitive, irrelevant, or overly argumentative. All comments will be taken under advisement by the Commission. No action will be taken at this time. Public Comments will be limited to 10 minutes per topic or 30 minutes total. The Commission may request an item be placed on a future agenda for further discussion as part of the regular meeting.
- Commissioner Comments/Updates.

b. Community Ed Report –Erin Bates

c. City Staff Report – Caleb

- Pine Valley Trail Proposal.
- Trail Names Meeting.
- COVID Protocols.
- Maintenance Activities

5. Action Items.

a. Pine Valley Master Plan.

b. Playground RFP Award.

a. Fee Waiver Request.

6. Future Items.

- Next Meeting (**Monday, May 3, 2021** – City Hall?)

7. Adjourn.

Regular Meeting.
Parks Commission February 1, 2021 - 4:30 p.m.
City Hall

Present: C. Martinson, T. Krohn, T. Urbanski, J. Badger, J. Fryc, J. Anderson
Absent: M. Krick
Staff: C. Peterson, K. Stedman, L. Anderson, R. Biebl
Others: E. Bates, K. Kolodge, A. Jerde, S. Buhs, B. Menze, J. Hutchinson

^{xc}
MINUTES

The minutes of the November 2, 2020 regular meeting were presented. Motion by J. Anderson and 2nd by T. Krohn to approve, motion carried 4-0.

COMMISSIONERS UPDATE/OTHER

Joshua Hutchinson presented his Eagle Scout Project. He will be building and placing park benches for the new single track trail at Pine Valley.

Public Comments:

A. Jerde said she had hoped there would be new faces in the Commission, and she wanted to discuss the naming of the trails. Staff advised that this was further down on the agenda.

COMMUNITY ED

Staff introduced the new Director of Community Ed, Erin Bates.

CITY STAFF REPORT

Staff provided a copy of the Bylaws to remind the group of the goals and calling for the Commission. Also, Boldt Co. is interested in sponsoring a clean-up day in and around Spafford Park and the river front, on or close to Earth Day. Due to the virtual meeting format, the joint Council and Park Commission meeting will be not be held in person. Two Commission members are asked to represent the group, Tim Krohn and Tom Urbanski volunteered. Staff discussed the Pinehurst and the Braun Park updates, Pinehurst Park will proceed this year and Braun Park in 2022. The recommendation will be that an RFP for new playground equipment be brought to the Council on February 2, 2021 for approval. Next on the agenda were the Pine Valley updates to include a new trail proposal to avoid varied uses crossing paths. There was a closure of one section of the Red Trail that crossed under the jump due to concerns of potential issues. A lengthy discussion ensued and the potential for new trails next year. The ski club also requested an additional rope tow which is not in the lease at this time. Additionally, more signage is needed for the various users. Staff admits there are growing pains as the park use is diversifying, and hopes are this will be worked out in the Master Plan. The naming of the trails will assist in way-finding and a suggested list was provided. The list includes older common names that are used now and some newly suggested names. A. Jerde inquired as to who votes on the final names and Staff said ultimately the council will vote. It was suggested that if any of the other user groups have strong feelings about a name they should come forward by the next meeting as the completion of naming and the ordering of signs will be done this spring.

Maintenance:

K. Stedman reports that the skating ribbon is finally in good shape due to all the cold weather. They have had a lot of positive comments about the fire ring as parents use it while kids are playing. Also, the Parks Facebook Page is used primarily for updates on maintenance. T. Krohn asked to also promote the Frozen Forester event on the page.

ACTION ITEMS

- a. The Commission approved the Community Education Agreement.
- b. The Chair and Vice Chair positions for 2021 were addressed. C. Martinson as Chair and J. Fryc as Vice-Chair are next in the rotation. T. Urbanski moved to accept these two appointments and J. Badger was a 2nd. (Motion approved 6-0)

NEXT MEETING

The next meeting to be held in April 5, 2021 - 4:30 p.m. as a web meeting.

On motion duly carried by a unanimous yea vote of all members present, the Parks Commission adjourned.

Secretary



Ski Jump Bypass Mt. Bike Trail Quote					
Customer			Recipient		
City of Cloquet 101 14 th Street Cloquet, MN 55720 Attn. Caleb Peterson			Trail Logic, LLC 228 99 th Ave W Duluth MN, 55808 218-451-0469 traillogicllc@gmail.com		
Trail building to be measured down centerline of trail. Actual footage may change but the unit prices are fixed.					
Qty.	Item#	Description	Unit Price		Line Total
2400'	1	Singletrack trail building	\$5.75/ft.		\$13,800.00
0	2	Bio-roll	\$3.00/ft		
0	3	Erosion Control Blanket	\$3.00/sq. yd.		
0	4	24" wide boardwalk	\$50.00/ft.		
Lump	5	Mobilization	\$500.00		\$500.00
				Total	\$14,300.00

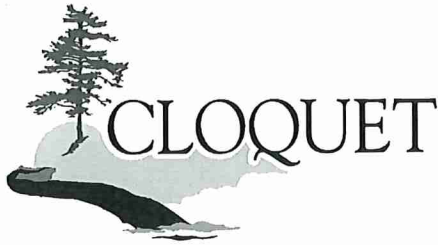

DEPARTMENT OF PUBLIC WORKS

101 14th Street; Cloquet, MN 55720
Phone: (218) 879-6758 Fax: (218) 879-6555
Street - Water - Sewer – Engineering - Park
www.cloquetmn.gov

REQUEST FOR ACTION

To: Park Commission
From: Caleb Peterson, Public Works Director
Date: April 5, 2021

ITEM DESCRIPTION: Pine Valley Master Plan Proposal.

Proposed Action

Staff recommends the Park Commission **MOVE RECOMMEND AWARD OF THE PROPOSAL FROM SHORT ELLIOT HENDRICKSON FOR COMPLETEION OF A MASTER PLAN FOR PINE VALLEY PARK IN THE AMMOUNT OF \$24,500.**

Background

In 2020 an application for “regional designation” for Pine Valley Park from the Greater Minnesota Regional Parks and Trails Commission (RMRPTC) received a “high” ranking. Regional status must be granted for the City to be eligible to apply for Legacy Funding. Regional significance is also a key component of the Local Option Sales Tax request currently in process with the Legislature. The 2020 application received a ranking of high indicating Pine Valley has a good chance of receiving regional designation. Before such designation can be granted, the City must complete a “Pine Valley Master Plan” meeting all the requirements of the GMRPTC.

Policy Objectives

Park Master Plan Policy 1.3: Improvements to parks shall follow a process that engages park users, stakeholders, and neighbors to ensures changes are aligned with community needs and interests.

Financial/Budget/Grant Considerations

No funding has been allocated for this Plan in the 2021 budget however the effort is critical to the ongoing sales tax designation. Staff is recommending this plan be completed as a fund balance expense. Legacy funds are not eligible for use on the hockey arenas but can be used to show regional significance and match any improvements to Pine Valley Park.

Supporting Documents Attached

S.E.H. Proposal.



Building a Better World
for All of Us®

February 11, 2021

RE: Pine Valley Park Master Plan
City of Cloquet, Minnesota
SEH No. CLOQU P-158498

Mr. Caleb Peterson
City Administrator
City of Cloquet
1307 Cloquet Avenue
Cloquet, MN 55720

Dear Mr. Peterson:

Short Elliott Hendrickson Inc. (SEH®) is pleased to submit this proposal for the Pine Valley Park Master Plan. This proposal is based on conversations with City staff, review of documents provided by the City, and our knowledge of the City from previous work.

Project Overview

We understand the City is interested in creating a Park Master Plan for Pine Valley Park whose purpose is to secure future state funding for park improvements. The process involves submitting a master plan document that meets the criteria established by the Greater Minnesota Regional Parks and Trails Commission (GMRPTC). The City recently applied for and received a High Ranking from GMRPTC, which is required prior to submitting a master plan. Public engagement is an important part of the required master plan process. The City has done some community outreach a few years ago and this information will be used as a starting point.

Work Plan

Task 1 Master Plan Preparation

The GMRPTC has a digital Master Plan template that is accessed from their website. The following tasks will need to be addressed to complete the Master Plan:

- Regional purpose/design goals
- Introduction/project overview
- Proposer/implementing agency
- Setting/regional context
- Site Inventory, analysis and pictures
- Vision, trends and public values
- Regional significance statement
- Conceptual master plan
- Ecological/land resources plan
- Programming plan
- Implementation, management and sustainability plan
- Preliminary cost estimate of proposed park components

SEH will work with City staff, Park Board and other stakeholders to prepare the narratives, maps, pictures/images and conceptual designs needed. We will input this information into the digital master plan template and review it with the City and stakeholders. When completed, a hard copy master plan document will be created.

Engineers | Architects | Planners | Scientists

Short Elliott Hendrickson Inc., 418 West Superior Street, Suite 200, Duluth, MN 55802-1512
SEH is 100% employee-owned | sehinc.com | 218.279.3000 | 888.722.0547 | 888.908.8166 fax

Task 2 Public Engagement Process

GMRPTC places an emphasis on integrating the public engagement process into the master plan development. Our intention is to work with City staff and create a public engagement plan that will do that efficiently and effectively. We propose the following process:

- Use the City Park Board as the community stakeholder group. This group already meets regularly, has knowledge of the park, and represents the community on park issues. We propose **three Park Board meetings** - kick-off/visioning, conceptual design review and draft master plan review. We would allow for the proper amount of input and feedback to successfully complete the Master Plan.
- **One Public Open House** that would be held virtually. The GMRPTC will want the most current input from as many stakeholders as possible. We feel that one open house, held at the beginning of the project would allow the general public to voice concerns, discuss issues and give input on the future park needs.
- **On-line Survey** is another important outreach tool that will allow the City to gather additional input from stakeholders, especially those who cannot attend the meetings in person. We propose that the City implement an on-line survey of residents to better understand what issues are important and what are areas of concern. SEH will assist the City in preparing the questions. The City will administer the survey and analyze the results. SEH will work with the City on incorporating the ideas/amenities into the Master Plan.
- SEH will prepare and **present the draft final Master Plan to the City Council** for final input prior to submittal to the GMRPTC.

Assumptions

Our work plan and deliverables were built on the following assumptions:

City will provide the following data:

- Previous public engagement comments on the park’s needs and desires
- Park inventory information
- Base plan data

No field survey efforts are included at this time.

The City’s point of contact will be Caleb Peterson. The City will lead the efforts to set up and notify the general public of the Park Board meetings and the virtual open house.

If additional tasks or meetings are needed, SEH will prepare an extra services agreement prior to completion of the work.

Schedule

We will begin work upon execution of a signed contract. We have outlined below some critical milestones and tentative dates:

Park Board (Virtual) Kick-off Meeting	April 2021
Open House (Virtual) – Visioning/Input	May 2021
Park Board (Virtual) Meeting – Design Review	June 2021
Park Board (Virtual) Meeting – Draft Master Plan	August 2021
Draft Final Master Plan – City Council	September 2021
Master Plan Submittal to GMRPTC	October 2021

Fee Estimate

We have estimated a total fee of \$24,500 to complete our services which would be billed on a Lump Sum basis. This fee includes all reimbursable expenses.

If this proposal meets your approval, we will forward a contract. We look forward to discussing this project with you further. If you have any questions, please contact me at **507.259.1492** or via e-mail at amasterpole@sehinc.com.

Sincerely,

SHORT ELLIOTT HENDRICKSON INC.



Andrew Masterpole, ASLA, LEED-AP (Lic. MN)
Project Manager

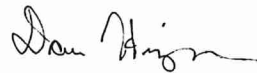

Dan Hinzmann, PE (Lic. MN, WI)
Client Service Manager

mh

\\sehinc.com\panzura\pzprojects\AE\C\CLOQU\155419\1-gen\10-setup-cont\03-proposal\Pine Valley Materials\Pine Valley Park Master Plan Proposal.docx

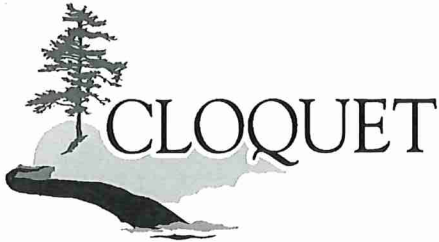

DEPARTMENT OF PUBLIC WORKS

101 14th Street; Cloquet, MN 55720
Phone: (218) 879-6758 Fax: (218) 879-6555
Street - Water - Sewer – Engineering - Park
www.cloquetmn.gov

REQUEST FOR ACTION

To: Park Commission
From: Caleb Peterson, Public Works Director
Date: April 5, 2021

ITEM DESCRIPTION: Braun Park Playground Award.

Proposed Action

Staff recommends the Park Commission **MOVE RECOMMEND THE PURCHASE OF PLAYGROUND EQUIPMENT FOR BRAUN PARK FROM _____ IN THE AMMOUNT OF \$45,000.**

Background

Replacement of the existing playground equipment at Braun Park is included as part of the approved budget and capital improvement plan for 2021. The existing equipment has reached the end of its useful life and recent safety inspections by staff have noted several issues which have required costly repair or closure of certain features.

To comply with purchasing regulations, playground safety recommendations, and ADA code staff proposals were solicited for design and supply of the replacement play structures. The actual demolition and installation would be performed by city crews resulting in a significant cost savings. Proposals will be evaluated at the April 5th Park Commission Meeting and their recommendation will be provided to Council.

Policy Objectives

Park Master Plan Policy 2.1: Best maintenance practices shall be established for all major park assets, including safety inspections, cleaning, repairs, and replacement timelines.

Park Master Plan Policy 2.5: All park resources shall be maintained in a way that ensures they are safe and attractive.

Financial/Budget/Grant Considerations

The approved budget for this improvement is \$60,000. The RFP allowed \$45,000 for design and supply of the features with \$15,000 held in reserve for other required materials such as footing concrete, playground chips and edger. The budget amount is comparable to the last neighborhood playground structure installed at Hilltop Park in 2015.

Supporting Documents Attached

Proposal Summaries.

Playground RFP Score Sheet

High score is best.

Supplier	Miracle	Miracle	Miracle	Miracle	Mn/Wisc.	Flagship	Example
	Option 1	Option 2	Option 1A	Option 1	Option 1	Option 1	
Design							
Play Value (1-10)							8
Overall Design (1-10)							9
Quality of Proposal (1-5)							4
Estimated Cost (1-5)							3
Other Factors (1-5)							4
TOTAL:							28

Ashley's Playground (Option 1) Cloquet, MN





Miracle Recreation Equip. Co.
 878 E. US Hwy 60
 Monett, MO 65708
 1-888-458-2752

QUOTE: R0013213022
 CUSTOMER: 5572A02
 Project: R0013_44235608840_06

Prepared For:

Accounts Payable
 CITY OF CLOQUET
 101 14th Street "NEW"
 CLOQUET, MN 55720
 218-879-3347 (phone)
 (218) 879-3122 (fax)
 karin.stedman@yahoo.com

Project Name & Location:

Ashley's Playground- Option
 1(No Timber)

Prepared by:

Webber Recreational Design, Inc.
 1442 Brooke Court
 Hastings, MN 55033
 (651) 438-3630 (phone)
 (651) 438-3939 (fax)
 jwebber@webberrec.com

Ship To Address:

Karin Stedman
 CITY OF CLOQUET
 410 Armory Road
 CLOQUET, MN 55720
 507-213-8116 (New) (phone)
 karin.stedman@yahoo.com

End User:

Karin Stedman
 CITY OF CLOQUET
 410 Armory Road
 CLOQUET, MN 55720
 507-213-8116 (New) (phone)
 karin.stedman@yahoo.com

Quote Number: R0013213022
 Quote Date: 2/23/2021
 Valid For: 30 Days From Quote Date

Freestanding

Product line: Freestanding
 Age group: 5-12

Components

Part Number	Description	Qty	Weight	Unit Price	Total
2740	SWG PART THERAPEUTIC SWG SEAT W/CHAIN (8' TR)	1	135.00	1,094.00	1,094.00
2840	SWG PART SLASH PROOF SEAT W/CHAIN (8' TR)	2	10.00	113.00	226.00
2990	SWG PART TOT SEAT 360 DEG W/CHAIN (8' TR)	1	15.00	166.00	166.00
4502	CONCERTO VIBES	1	135.00	4,235.00	4,235.00
7188522	3 1/2" OD ARCH SWG FRAME ONLY 2 SEATS REQ MC	2	200.00	1,242.00	2,484.00
7188522X	3 1/2" OD ARCH ADD-A-BAY 2 SEATS REQ MC	1	170.00	684.00	684.00
787002	WELCOME SIGN AGES 2-12, FREESTANDING	1	60.00	579.00	579.00
9452	SADDLE SEAT, STRAIGHT POST	1	65.00	672.00	672.00
953	ATV "C" SPRING RIDER	1	135.00	1,228.00	1,228.00

2-12 Equipment

Product line: TotsChoiceX

Age group: 2-12

Components

Part Number	Description	Qty	Weight	Unit Price	Total
7045029	SQUARE DECK ATTACHES TO (4) 3-1/2" POSTS	1	120.00	1,023.00	1,023.00
7045039	1/2 HEX FULL DECK ATTACH TO (4) 3-1/2" POSTS	2	150.00	1,360.00	2,720.00
7045109	RECT OPEN DECK ATTACHES TO (6) 3-1/2" POSTS	1	200.00	1,932.00	1,932.00
7046195	POD HOPPER (5' DECK)	1	290.00	3,599.00	3,599.00
7046701	CHAMELEON II ENTRY & EXIT 5' - 6'6"	1	145.00	2,162.00	2,162.00
7046706	CHAMELEON II LEFT SECTION	1	25.00	510.00	510.00
7046706	CHAMELEON II LEFT SECTION	1	25.00	510.00	510.00
70471312	SENSORY PANEL TEXTURED TRIANGLE HEXAGON	1	55.00	1,794.00	1,794.00
70471510	SIGN LANGUAGE PANEL	1	45.00	1,237.00	1,237.00
7047306	HEXAGON TREEHOUSE ROOF	1	390.00	2,379.00	2,379.00
70474859	6'2" TYPHOON II SLIDE 360 DEG (5' DECK)	1	1,500.00	6,097.00	6,097.00
7047631	CRITTER PUZZLE PANEL	1	50.00	1,198.00	1,198.00
704787	TOT ROCK CLIMBER (3' DECK)	1	110.00	1,161.00	1,161.00
704796P1	BELL (POST MOUNT)	1	10.00	163.00	163.00
7048153	VERTICAL LADDER CLIMBER (3' DECK)	1	100.00	668.00	668.00
704817B	WALL ENCLOSURE W/SEAT (BELOW DECK)	1	70.00	850.00	850.00
70485139	SQUARE TRANSFER POINT W/CLOSED HR (3' DECK)	1	225.00	2,864.00	2,864.00
7048614	SQUARE ROOF, DOUBLE WALL	2	300.00	1,075.00	2,150.00
704900P1	STEERING WHEEL (POST MOUNT)	1	5.00	163.00	163.00
7049071	"L" SLIDE RH, ROCKITE (3' DECK)	1	100.00	1,199.00	1,199.00
704908	SPIDER CLIMBER (3, 5' OR 6'6" DECK)	1	70.00	1,067.00	1,067.00
70495949	ADA STAIRS BETWEEN DECKS W/2' RISE 4' SPAN	1	200.00	3,052.00	3,052.00
70497049	4' ARCH BRIDGE BETWEEN DECKS	1	165.00	3,025.00	3,025.00
7049922	LOOKOUT TOWER	1	50.00	963.00	963.00
714999Z	CUSTOMER SERVICE KIT (NO PRICE)	1	7.00	0.00	0.00
718552	3 1/2" OD X 130" POST (3' TO 5' DECKS)	2	40.00	188.00	376.00
718572	3 1/2" OD X 138" POST FOR ROOF (3'DK OR LESS)	6	40.00	164.00	984.00
718573	3 1/2" OD X 162" POST FOR ROOF (3'6" TO 5'DK)	8	50.00	190.00	1,520.00
994167BK	FRICTION WEAR MAT - 32" x 54", BLACK	9	80.00	140.00	1,260.00

RiskSign_Included

Product line: Freestanding
Age group:

Components

Part Number	Description	Qty	Weight	Unit Price	Total
787Z	RISK MANAGEMENT SIGN - ENGLISH (NO PRICE)	1	0.00	0.00	0.00

Additional Items

Part Number	Description	Qty	Weight	Unit Price	Total
925961	THUMB DRIVE 2GB - MREC	1	0.00	0.00	0.00
926021	MREC CARD F/THUMB DRIVE	1	0.00	0.00	0.00
INSTALL BOOK	INSTALL BOOK FOR PP ORDERS	1	0.00	0.00	0.00

Totals:

Equipment Weight: 7,432.00 lbs
Equipment List: \$57,994.00
Discount Amount: -\$16,000.00
Equipment Price: \$41,994.00
Freight: \$2,823.73
Grand Total: \$44,817.73

Notes:

This Quote shall not become a binding contract until signed and delivered by both Customer and Miracle Recreation Equipment Company ("Miracle"). Sales Representative is not authorized to sign this Quote on behalf of Miracle or Customer, and signed Quotes cannot be accepted from Sales Representative. To submit this offer, please sign below and forward a complete signed copy of this Quote directly to "Miracle Sales Administration" via fax (417) 235-3551 or email: orders@miraclerec.com. Upon acceptance, Miracle will return a fully-signed copy of the Quote to Customer (with copy to Sales Representative) via fax or email.

THIS QUOTE IS LIMITED TO AND GOVERNED BY THE TERMS CONTAINED HEREIN. Miracle objects to any other terms proposed by Customer, in writing or otherwise, as material alterations, and all such proposed terms shall be void. Customer authorizes Miracle to ship the Equipment and agrees to pay Miracle the total amount specified. Shipping terms are FOB the place of shipment via common carrier designated by Miracle. Payment terms are Net-30 days from invoice date with approved credit and all charges are due and payable in full at PO Box 734154, Dallas, TX 75373-4154, unless notified otherwise by Miracle in writing. Customer agrees to pay all additional service charges for past due invoices. Customer must provide proper tax exemption certificates to Miracle, and shall promptly pay and discharge all otherwise applicable taxes, license fees, levies and other impositions on the Equipment at its own expense. Purchase orders and payments should be made to the order of Miracle Recreation Equipment Company.

Quote Number: R0013213022 **Quote Date:** 2/23/2021 **Equipment:** \$57,994.00 **Grand Total:** \$44,817.73

CUSTOMER HEREBY SUBMITS ITS OFFER TO PURCHASE THE EQUIPMENT ACCORDING TO THE TERMS STATED IN THIS QUOTE AND SUBJECT TO FINAL APPROVAL BY MIRACLE.

Ashley's Playground (Option 2- No Timbers) Cloquet, MN

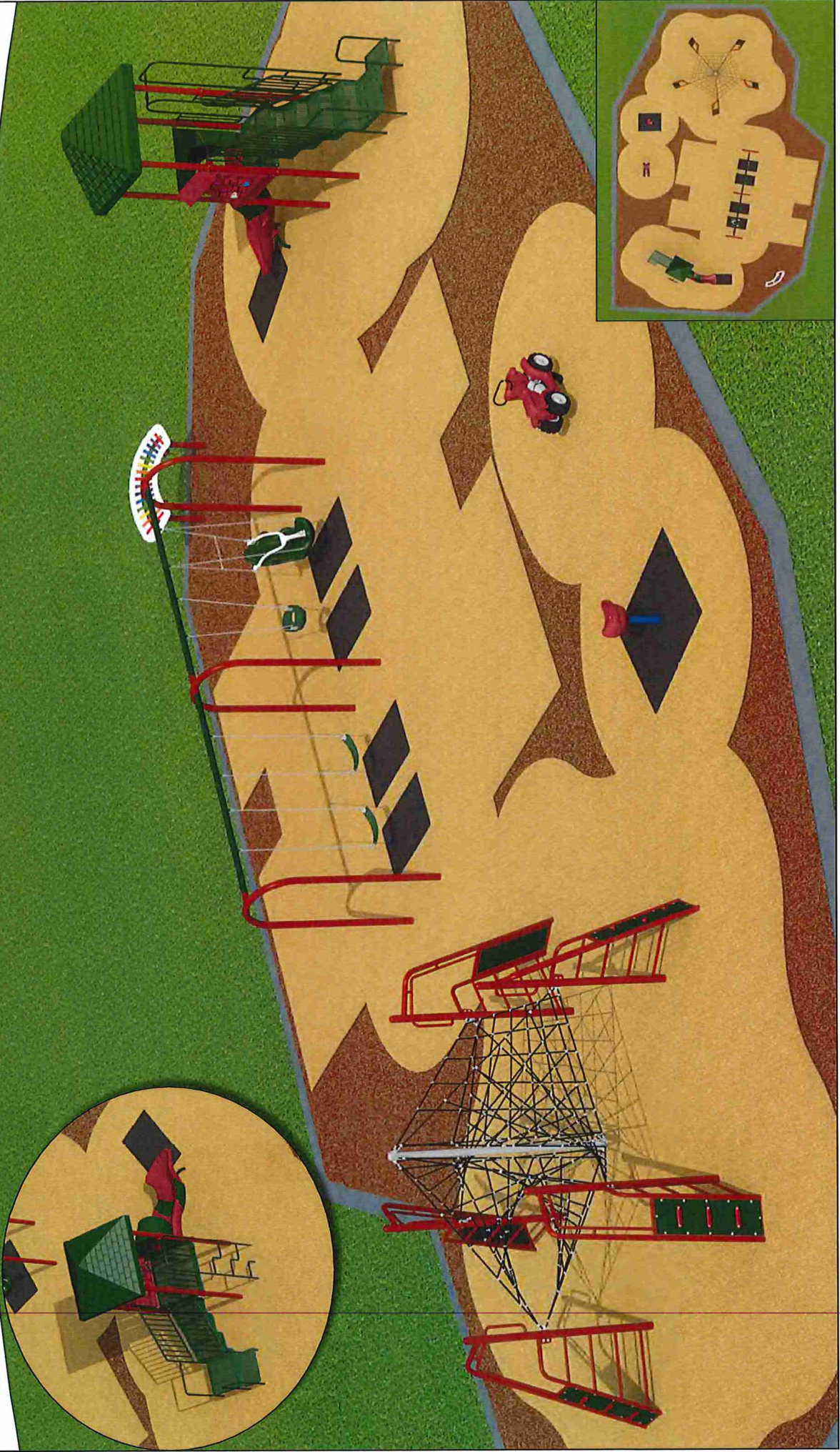



Miracle Recreation Equip. Co.
878 E. US Hwy 60
Monett, MO 65708
1-888-458-2752

QUOTE: R0013213025
CUSTOMER: 5572A02
Project: R0013_44239633934_06

Prepared For:

Accounts Payable
CITY OF CLOQUET
101 14th Street "NEW"
CLOQUET, MN 55720
218-879-3347 (phone)
(218) 879-3122 (fax)
karin.stedman@yahoo.com

Project Name & Location:

Ashley's Playground-
Option 2 (No Timber)

Prepared by:

Webber Recreational Design, Inc.

1442 Brooke Court
Hastings, MN 55033
(651) 438-3630 (phone)
(651) 438-3939 (fax)
jwebber@webberrec.com

Ship To Address:

Karin Stedman
CITY OF CLOQUET
410 Armory Road
CLOQUET, MN 55720
507-213-8116 (New) (phone)
karin.stedman@yahoo.com

End User:

Karin Stedman
CITY OF CLOQUET
410 Armory Road
CLOQUET, MN 55720
507-213-8116 (New) (phone)
karin.stedman@yahoo.com

Quote Number: R0013213025
Quote Date: 2/23/2021
Valid For: 30 Days From Quote Date

Freestanding

Product line: Freestanding
Age group: 5-12

Components

Part Number	Description	Qty	Weight
2740	SWG PART THERAPEUTIC SWG SEAT W/CHAIN (8' TR)	1	135.00
2840	SWG PART SLASH PROOF SEAT W/CHAIN (8' TR)	2	10.00
2990	SWG PART TOT SEAT 360 DEG W/CHAIN (8' TR)	1	15.00
4502	CONCERTO VIBES	1	135.00
4631	HOVER NET	1	1,750.00
7188522	3 1/2" OD ARCH SWG FRAME ONLY 2 SEATS REQ MC	2	200.00
7188522X	3 1/2" OD ARCH ADD-A-BAY 2 SEATS REQ MC	1	170.00
787002	WELCOME SIGN AGES 2-12, FREESTANDING	1	60.00
925920Z	TOUCH UP PAINT KIT - FREESTANDING (NO PRICE)	1	2.00
994167BK	FRICTION WEAR MAT - 32" x 54", BLACK	7	80.00

2-12 Equipment

Product line: TotsChoiceX

Age group: 2-12

Components

Part Number	Description	Qty	Weight
7185029	SQUARE DECK (ATTACHES TO 4 POSTS)	1	100.00
718573	3 1/2" OD X 162" POST FOR ROOF (3'6" TO 5'DK)	4	50.00
718670	CHAMELEON II ENTRY & EXIT 2'6" - 4'6"	1	125.00
7186706	CHAMELEON II LEFT SECTION	1	60.00
718719	CLIFF CLIMBER (3' & 5' DECK)	1	75.00
7187634	DINOSAUR PANEL	1	50.00
71885149	SQUARE TRANSFER POINT W/CLOSED HR (4' DECK)	1	285.00
7188614	60" SQUARE ROOF-SHINGLE, DOUBLE WALL	1	135.00
718999Z	CUSTOMER SERVICE KIT (NO PRICE)	1	7.00
9452	SADDLE SEAT, STRAIGHT POST	1	65.00
953	ATV "C" SPRING RIDER	1	135.00

RiskSign_Included

Product line: Freestanding

Age group:

Components

Part Number	Description	Qty	Weight
787Z	RISK MANAGEMENT SIGN - ENGLISH (NO PRICE)	1	0.00

Additional Items

Part Number	Description	Qty	Weight
925961	THUMB DRIVE 2GB - MREC	1	0.00
926021	MREC CARD F/THUMB DRIVE	1	0.00
INSTALL BOOK	INSTALL BOOK FOR PP ORDERS	1	0.00

Totals:

Equipment Weight:	4,484.00 lbs
Equipment List:	\$38,959.00
Discount Amount:	-\$9,495.00
Equipment Price:	\$29,464.00
Freight:	\$1,898.84
Grand Total:	\$31,362.84



Webber
Recreational Design, Inc.

Ashley's Playground (Option 1A- No Timbers) Cloquet, MN

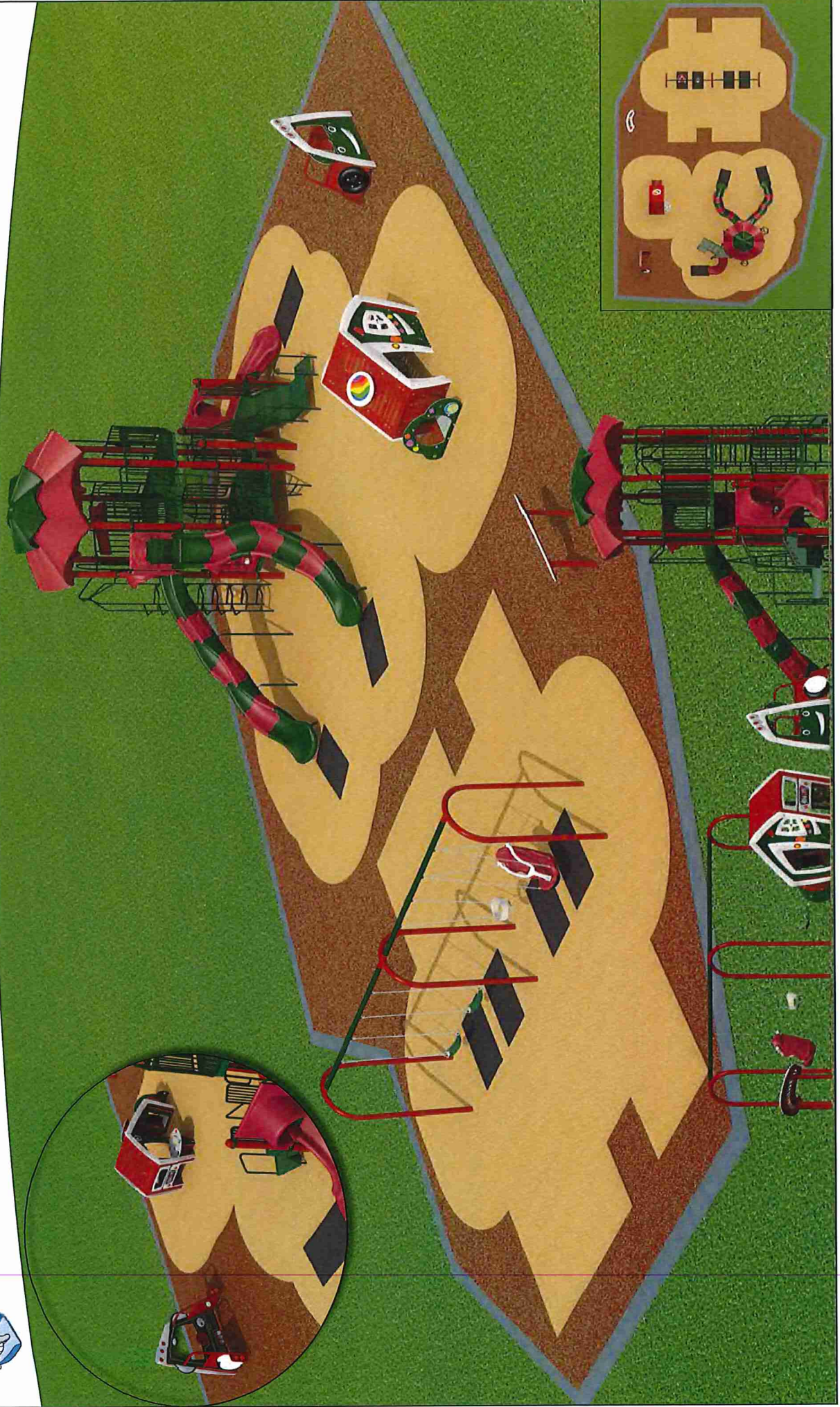



Miracle Recreation Equip. Co.
878 E. US Hwy 60
Monett, MO 65708
1-888-458-2752

QUOTE: R0013213038
CUSTOMER: 5572A02
Project: R0013_44263527263_01

Prepared For:

Accounts Payable
CITY OF CLOQUET
101 14th Street "NEW"
CLOQUET, MN 55720
218-879-3347 (phone)
(218) 879-3122 (fax)
karin.stedman@yahoo.com

Project Name & Location:

Ashley's Playground-
Option 1A No Timber

Prepared by:

Webber Recreational Design, Inc.

1442 Brooke Court
Hastings, MN 55033
(651) 438-3630 (phone)
(651) 438-3939 (fax)
jwebber@webberrec.com

Ship To Address:

Karin Stedman
CITY OF CLOQUET
410 Armory Road
CLOQUET, MN 55720
507-213-8116 (New) (phone)
karin.stedman@yahoo.com

End User:

Karin Stedman
CITY OF CLOQUET
410 Armory Road
CLOQUET, MN 55720
507-213-8116 (New) (phone)
karin.stedman@yahoo.com

Quote Number: R0013213038
Quote Date: 3/8/2021
Valid For: 30 Days From Quote Date

5-12

Product line: KidsChoice
Age group: 5-12

Components

Part Number	Description	Qty	Weight
2740	SWG PART THERAPEUTIC SWG SEAT W/CHAIN (8' TR)	1	135.00
2840	SWG PART SLASH PROOF SEAT W/CHAIN (8' TR)	2	10.00
4502	CONCERTO VIBES	1	135.00
7145019	TRIANGLE DECK (ATTACHES TO 3 POSTS)	1	75.00
71451828	XG HEXTAGON MEGA TWR 2-LEVEL (2' & 8' DECK))	1	1,400.00
7145493	5" OD X 112" POST (3' DECK)	3	65.00
7146058	TREE-O CLIMBER (8' DECK)	1	180.00
7146078	BRAIDED CLIMBER (8' DECK)	1	140.00
7146704	CHAMELEON II SHORT STRAIGHT SECTION	1	60.00
7146704	CHAMELEON II SHORT STRAIGHT SECTION	1	60.00
7146705	CHAMELEON II RIGHT SECTION	1	60.00
7146705	CHAMELEON II RIGHT SECTION	3	60.00
7146706	CHAMELEON II LEFT SECTION	2	60.00
7146706	CHAMELEON II LEFT SECTION	2	60.00
714670M22	CHAM II DBL SLIDE ENTRY/EXIT (7'-8'6" DK)	1	350.00

7146806C	WAVE HEX ROOF W/TOPPER	1	360.00
71472110	CANYON CLIMBER (10' DECK)	1	160.00
7147634	DINOSAUR PANEL	1	50.00
714796P1	BELL (POST MOUNT)	1	10.00
7148109	ADA STAIRS BETWEEN DECKS W/1' RISE	1	120.00
7148135	DECK ENCL FOR OVERHEAD CLIMBERS (ONLY)	3	35.00
714816W	FULL WAVE BARRIER, TUBE	1	35.00
7148496	OBSERVATION DECK W/EXTENDED STEERING WHEEL	1	110.00
71485139	SQUARE TRANSFER POINT W/CLOSED HR (3' DECK)	1	225.00
71486859	M'THERM STEPS GROUND TO 2' DECK OPEN HNDR	1	150.00
714900P1	STEERING WHEEL (POST MOUNT)	1	5.00
7149071	"L" SLIDE RH, ROCKITE (3' DECK)	1	100.00
714999Z	CUSTOMER SERVICE KIT (NO PRICE)	1	7.00
7188522	3 1/2" OD ARCH SWG FRAME ONLY 2 SEATS REQ MC	2	200.00
7188522X	3 1/2" OD ARCH ADD-A-BAY 2 SEATS REQ MC	1	170.00
787003	WELCOME SIGN AGES 5-12, FREESTANDING	1	60.00
994167BK	FRICTION WEAR MAT - 32" x 54", BLACK	3	80.00

2-5

Product line: TotsChoiceX
Age group: 2-5

Components

Part Number	Description	Qty	Weight
2990	SWG PART TOT SEAT 360 DEG W/CHAIN (8' TR)	1	15.00
787001	WELCOME SIGN AGES 2-5, FREESTANDING	1	60.00
994167BK	FRICTION WEAR MAT - 32" x 54", BLACK	4	80.00
MR0881	MINI CITY TRUCK	1	270.00
MR0882	MINI CITY PLAYHOUSE	1	855.00

RiskSign_Included

Product line: Freestanding
Age group:

Components

Part Number	Description	Qty	Weight
787Z	RISK MANAGEMENT SIGN - ENGLISH (NO PRICE)	1	0.00

Additional Items

Part Number	Description	Qty	Weight
925961	THUMB DRIVE 2GB - MREC	1	0.00
926021	MREC CARD F/THUMB DRIVE	1	0.00
INSTALL BOOK	INSTALL BOOK FOR PP ORDERS	1	0.00

Totals:

Equipment Weight:	7,057.00 lbs
Equipment List:	\$63,837.00
Discount Amount:	-\$21,518.12
Equipment Price:	\$42,318.88
Freight:	\$2,681.12
Grand Total:	\$45,000.00

Notes:

This Quote shall not become a binding contract until signed and delivered by both Customer and Miracle Recreation Equipment Company ("Miracle"). Sales Representative is not authorized to sign this Quote on behalf of Miracle or Customer, and signed Quotes cannot be accepted from Sales Representative. To submit this offer, please sign below and forward a complete signed copy of this Quote directly to "Miracle Sales Administration" via fax (417) 235-3551 or email: orders@miraclerec.com. Upon acceptance, Miracle will return a fully-signed copy of the Quote to Customer (with copy to Sales Representative) via fax or email.

THIS QUOTE IS LIMITED TO AND GOVERNED BY THE TERMS CONTAINED HEREIN. Miracle objects to any other terms proposed by Customer, in writing or otherwise, as material alterations, and all such proposed terms shall be void. Customer authorizes Miracle to ship the Equipment and agrees to pay Miracle the total amount specified. Shipping terms are FOB the place of shipment via common carrier designated by Miracle. Payment terms are Net-30 days from invoice date with approved credit and all charges are due and payable in full at PO Box 734154, Dallas, TX 75373-4154, unless notified otherwise by Miracle in writing. Customer agrees to pay all additional service charges for past due invoices. Customer must provide proper tax exemption certificates to Miracle, and shall promptly pay and discharge all otherwise applicable taxes, license fees, levies and other impositions on the Equipment at its own expense. Purchase orders and payments should be made to the order of Miracle Recreation Equipment Company.

Quote Number: R0013213038 **Quote Date:** 3/8/2021 **Equipment:** \$63,837.00 **Grand Total:** \$45,000.00

CUSTOMER HEREBY SUBMITS ITS OFFER TO PURCHASE THE EQUIPMENT ACCORDING TO THE TERMS STATED IN THIS QUOTE AND SUBJECT TO FINAL APPROVAL BY MIRACLE.

Submitted By	Printed Name and Title	Date
THE FOREGOING QUOTE AND OFFER ARE HEREBY APPROVED AND ACCEPTED BY MIRACLE RECREATION EQUIPMENT		
By:		Date:

ADDITIONAL TERMS & CONDITIONS OF SALE

- 1. Use & Maintenance.** Customer agrees to regularly inspect and maintain the Equipment, and to provide, inspect and maintain appropriate safety surfacing under and around the Equipment, in accordance with Miracle's product literature and the most current Consumer Product Safety Commission Handbook for Public Playground Safety.
- 2. Default, Remedies & Delinquency Charges.** Customer's failure to pay any invoice when due, or its failure to otherwise comply with the terms of this Quote, shall constitute a default under all unsatisfied invoices ("Event of Default"). Upon an Event of Default, Miracle shall have all remedies available to it at law or equity, including, without limitation, all remedies afforded a secured creditor under the Uniform Commercial Code. Customer agrees to assist and cooperate with Miracle to accomplish its filing and enforcement of mechanic's or other liens with respect to the Equipment or its location or its repossession of the Equipment, and Customer expressly waives all rights to possess the Equipment after an Event of Default. All remedies are cumulative and not alternative, and no exercise by Miracle of a remedy will prohibit or waive the exercise of any other remedy. Customer shall pay all reasonable attorneys fees plus any costs of collection incurred by Miracle in enforcing its rights hereunder. Subject to any limitations under law, Customer shall pay to Miracle as liquidated damages, and not as a penalty, an amount equal to 1.5% per month of any payment that is delinquent in such month and is not received by Miracle within ten (10) days after the date on which due.
- 3. Limitation of Warranty/ Indemnity.** MIRACLE MAKES NO EQUIPMENT WARRANTIES EXCEPT FOR THOSE STANDARD

Ashley's Playground (Option 1A- No Timbers) Cloquet, MN



Webber
Recreational Design, Inc.

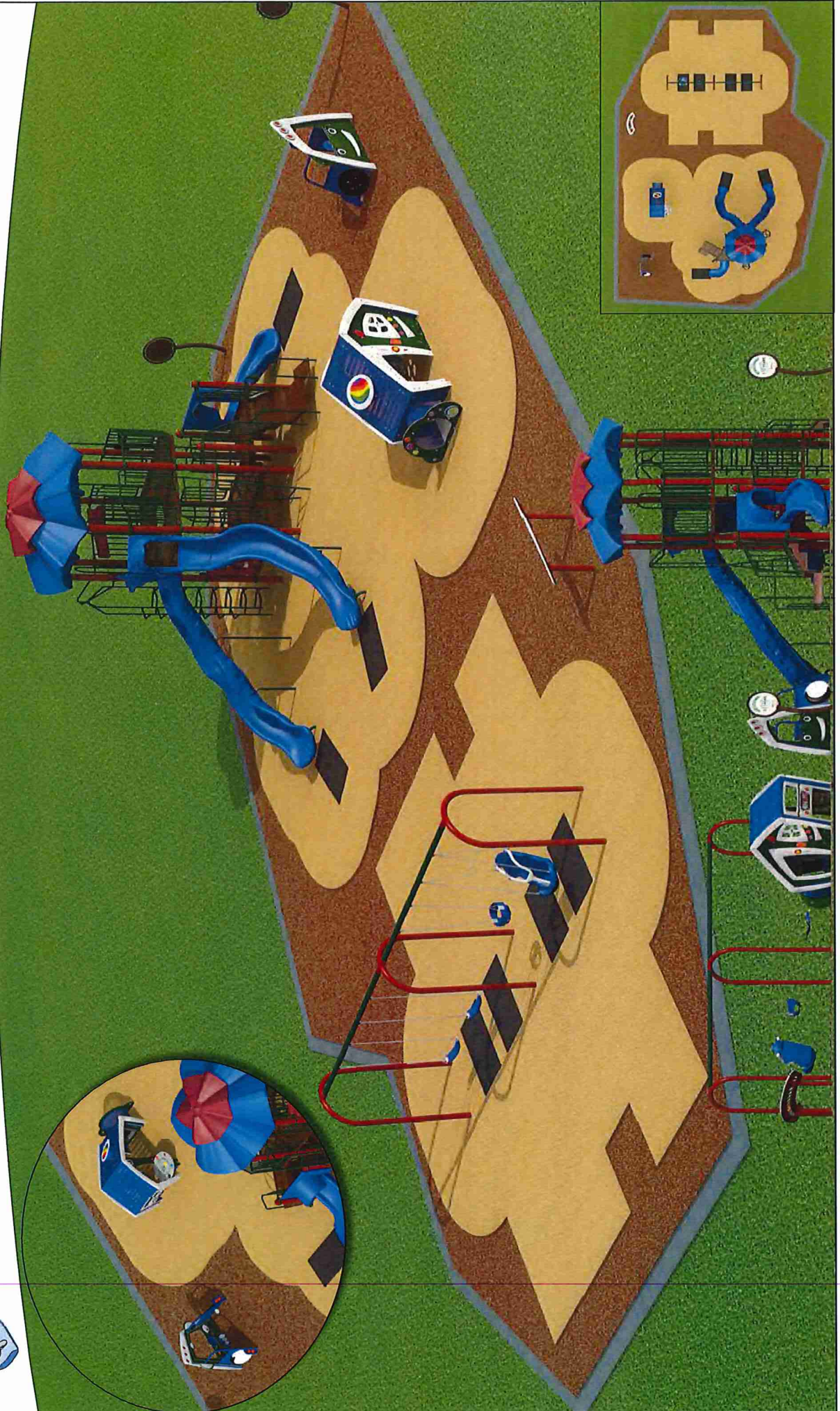

**“PROPOSAL FOR THE
DESIGN AND SUPPLY OF PLAY EQUIPMENT
FOR ASHLEY’S PLAYGROUND
AT BRAUN PARK”
CLOQUET, MINNESOTA**

DUE: FEBRUARY 23, 2021 NO LATER THAN 4:00 PM

Minnesota Playground Inc., dba, Minnesota Wisconsin Playground

P.O. Box 27328

Golden Valley, MN 55427

(763) 546-7787

Company Contacts:

Tim Newgard, Sales Representative

Phone (715) 441-5003, email: tim@mnwiplay.com

Eric Denning, General Manager

Phone (763) 546-7787, email: eric@mnwiplay.com

Minnesota Playground INC., dba Minnesota Wisconsin Playground
P.O. Box 27328 | Golden Valley, MN 55427
1-800-622-5425 | 763-546-7787 | (F) 763-546-5050
info@mnwiplay.com | www.mnwiplay.com



Minnesota / Wisconsin Playground
 5101 Highway 55, Suite 6000
 Golden Valley, Minnesota 55422
 Ph. 800-622-5425 | 763-546-7787
 Fax 763-546-5050 | tim@mnwiplay.com

02/22/2021
 Quote #101091-01-01

CONSULTANT: TIM NEWGARD

Ashley's Playground at Braun Park - D10498T - Supply of Materials Only

City of Cloquet
 Attn: Caleb Peterson
 1307 Cloquet Ave
 Cloquet, MN 55720
 Phone: 218-879-6758
 Fax: 218-879-6555
 cpeterson@ci.cloquet.mn.us

Ship to Zip 55720

Quantity	Part #	Description	Unit Price	Amount
1	RDU	GameTime - Primetime Play Unit, ages 5-12- Installation by Owner	\$32,696.33	\$32,696.33
		(1) 19097 -- Schooner (5'-6" & 6')		
		(1) 19835 -- Face Creator Panel		
		(1) 19772 -- Chain Pod Climber 6'/6'6"		
		(1) 19351 -- Vert Wall 8'		
		(1) 19217 -- Bubble (3' & 3'6")		
		(1) 19755 -- Wiggle Climber Attachment		
		(1) 12728 -- Single Seat P/T		
		(1) 18679 -- Bongos		
		(1) 19035 -- Optional Access Step (3' & 5')		
		(1) 19285 -- Transfer Platform W/ Guardrail 3'		
		(3) 18200 -- 36" Sq Punched Deck P/T 1.3125		
		(1) 19287 -- River Rock Climber		
		(1) 19125 -- Wave Zip Slide (6')		
		(1) 19007 -- Transfer System W/Barrier (3' Rise)		
		(1) 19752 -- Traverse Climber		
		(1) 19372 -- Play Port Bridge		
		(1) 18318 -- 6'-0" F5 Spiral Slide		
		(4) 18201 -- 36" Tri Punched Deck P/T		
		(1) 19669 -- Whirlwind Climber 8'		
		(1) 19005 -- Transfer System W/Barrier (2' Rise)		
		(1) 19427 -- Single Spiral		
		(5) G12069 -- 3 1/2" Uprt Ass'Y Galv 14'		
		(3) 12068 -- 3 1/2" Uprt Ass'Y Alum 13'		
		(7) 12027 -- 3 1/2" Uprt Ass'Y Alum 12'		





Minnesota / Wisconsin Playground
 5101 Highway 55, Suite 6000
 Golden Valley, Minnesota 55422
 Ph. 800-622-5425 | 763-546-7787
 Fax 763-546-5050 | tim@mnwiplay.com

02/22/2021
 Quote #101091-01-01

CONSULTANT: TIM NEWGARD

Ashley's Playground at Braun Park - D10498T - Supply of Materials Only

Quantity	Part #	Description	Unit Price	Amount
		(3) 12025 -- 3 1/2" Uprt Ass'Y Alum 10'		
		(1) 12024 -- 3 1/2" Uprt Ass'Y Alum 9'		
		(1) 12069 -- 3 1/2"Uprt Ass'Y Alum 14'		
1	RDU	GameTime - Primetime Swings, ages 2-12- Installation by Owner	\$3,466.00	\$3,466.00
		(1) 8555 -- 3 1/2" Zero-G Chair (2-5)-Galv Chain		
		(1) 8696 -- Encl Seat 3 1/2"(8696)		
		(2) 8910 -- Belt Seat 3 1/2"Od(8910)		
		(1) 12584 -- Ada Primetime Swing Aab, 3 1/2" Od		
		(1) 18826 -- Primetime Swing 3 1/2" X 8'		
1	6246	GameTime - Solo Spinner	\$1,660.00	\$1,660.00
1	6279l	GameTime - Duck Spring Rider	\$967.00	\$967.00
1	5180	GameTime - Welcome Sign (2-5 or 5-12)	\$512.00	\$512.00
6	161292	GameTime - Wear Mat 44"x48"	\$245.00	\$1,470.00
1	178749	GameTime - Owner's Kit	\$60.00	\$60.00
1	Playcurb	Other - 12" Playcurb - 4ft - Qty. 57 - #4862- Add = \$3662.00 Includes freight (57) 12" tall playcurbs, 4 ft long Quantity will cover the perimeter of the existing playout in replacement of the existing border. Does not include installation.		
			Sub Total	\$40,831.33
			Freight	\$4,168.67
			Total	\$45,000.00

Comments

Owner is responsible to prepare and provide a flat and level site prior for play equipment. Owner will provide all labor and installation of play equipment and safety surfacing and border. Owner be responsible for demolition and disposal of existing play equipment and safety surfacing as needed.

This quotation is subject to current Minnesota/Wisconsin Playground (MWP) policies as well as the following terms and conditions. Our quotation is based on shipment of all items at one time to a single destination, unless noted, and changes are subject to price adjustment. Purchases in excess of \$1,000.00 to be supported by your written purchase order made out to Minnesota/Wisconsin Playground.

Each quote is handled on a per order/project basis. Unless a long-term agreement is in place between purchaser and MWP, terms and conditions of this quotation shall be as outlined herein with no other requirements applicable.



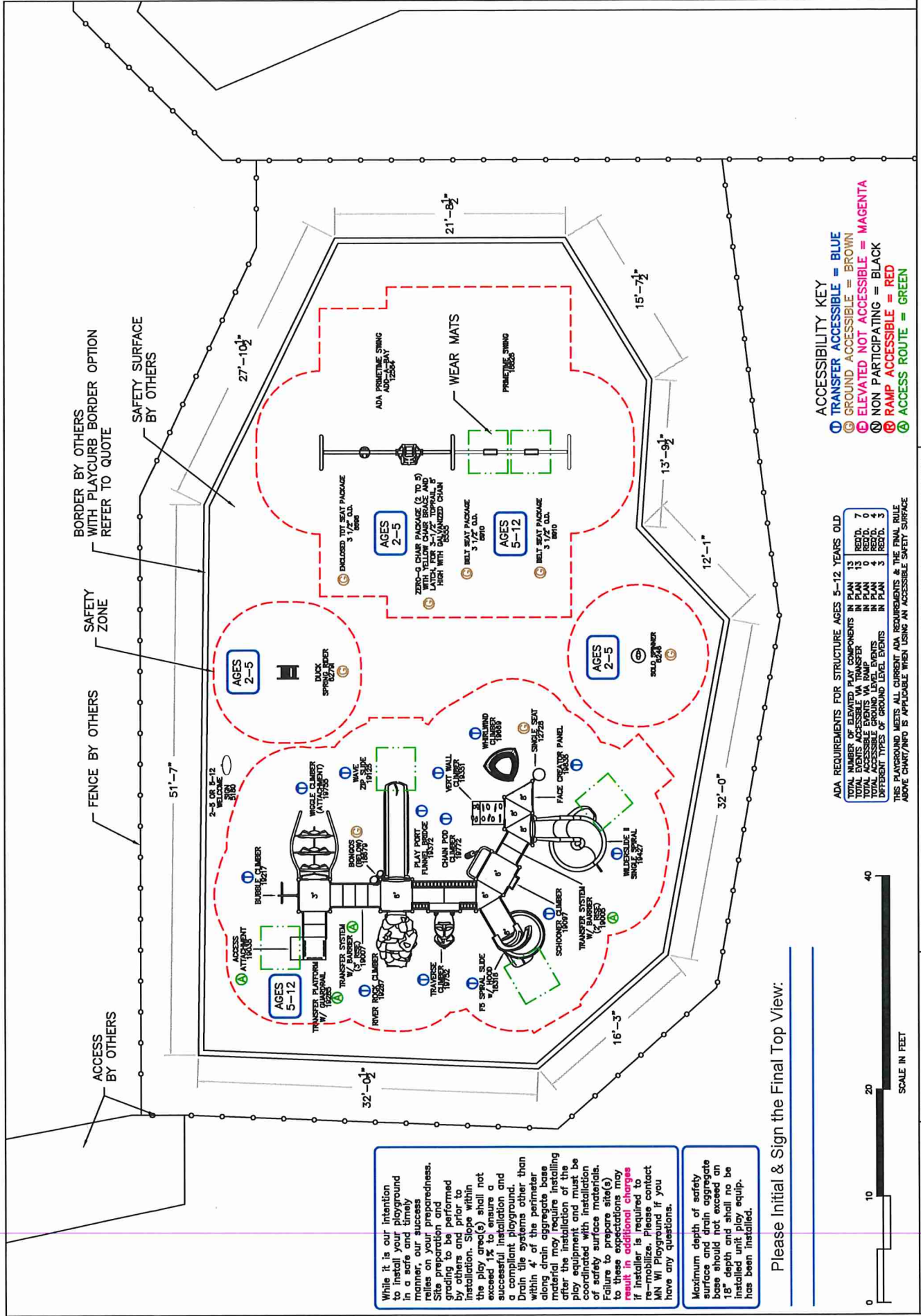

BORDER BY OTHERS WITH PLAYCURB BORDER OPTION REFER TO QUOTE

SAFETY SURFACE BY OTHERS

SAFETY ZONE

FENCE BY OTHERS

ACCESS BY OTHERS

While it is our intention to install your playground in a safe and professional manner, our success relies on your preparedness. Site preparation and grading to be performed by others and prior to installation. Slope within the play area(s) shall not exceed 1% to ensure a successful installation and a compliant playground. Drain tile systems other than within 4' of the perimeter along drain aggregate base material may require installing after the installation of the play equipment and must be coordinated with installation safety surfaces materials. Failure to prepare site properly may result in additional charges if installer is required to re-mobilize. Please contact MN WJ Playground if you have any questions.

Maximum depth of safety surface and drain aggregate base should not exceed on 18" depth and shall not be installed until play equip. has been installed.

Please Initial & Sign the Final Top View:

- ACCESSIBILITY KEY**
- ⓐ TRANSFER ACCESSIBLE = BLUE
 - ⓑ GROUND ACCESSIBLE = BROWN
 - ⓒ ELEVATED NOT ACCESSIBLE = MAGENTA
 - ⓓ NON PARTICIPATING = BLACK
 - ⓔ RAMP ACCESSIBLE = RED
 - ⓕ ACCESS ROUTE = GREEN

ADA REQUIREMENTS FOR STRUCTURE AGES 5-12 YEARS OLD

TOTAL NUMBER OF ELEVATED PLAY COMPONENTS	IN PLAN	13	7
TOTAL EVENTS ACCESSIBLE VIA TRANSFER	IN PLAN	0	0
TOTAL ACCESSIBLE EVENTS VIA RAMP	IN PLAN	0	0
DIFFERENT TYPES OF GROUND LEVEL EVENTS	IN PLAN	3	3

THIS PLAYGROUND MEETS ALL CURRENT ADA REQUIREMENTS & THE FINAL BLUE ASSESSMENT IS APPLICABLE WHEN USING AN ACCESSIBLE SAFETY SURFACE



SCALE: 1" = 12'-0"

Mfg. By: **GAME TIME** PLAYGROUND COMPANY
Enriching Childhood Through Play.

Sold & Distributed By: **MINNESOTA WISCONSIN PLAYGROUND**
763-546-7787 1-800-622-5425
Fax 763-546-5050 E-Mail info@mnwplay.com

ASHLEY'S PLAYGROUND - BRAUN PARK
Cloquet, Minnesota
2-22-21 DWG. D10498T

THIS PLAN REQUIRES A FINISHED GRADE RESOLUTION



P.O. Box 27328 | Golden Valley, MN 55427
1-800-622-5425 | 763-546-7787 | (F) 763-546-5050
info@mnwiplay.com | www.mnwiplay.com

COLORS OPTION #1

UPRIGHTS: BROWN

DECKS: BROWN

PLASTIC: GREEN

ACCENT METAL: BEIGE

HDPE: BEIGE & GREEN

Ashley's Playground - Braun Park

Cloquet, Minnesota

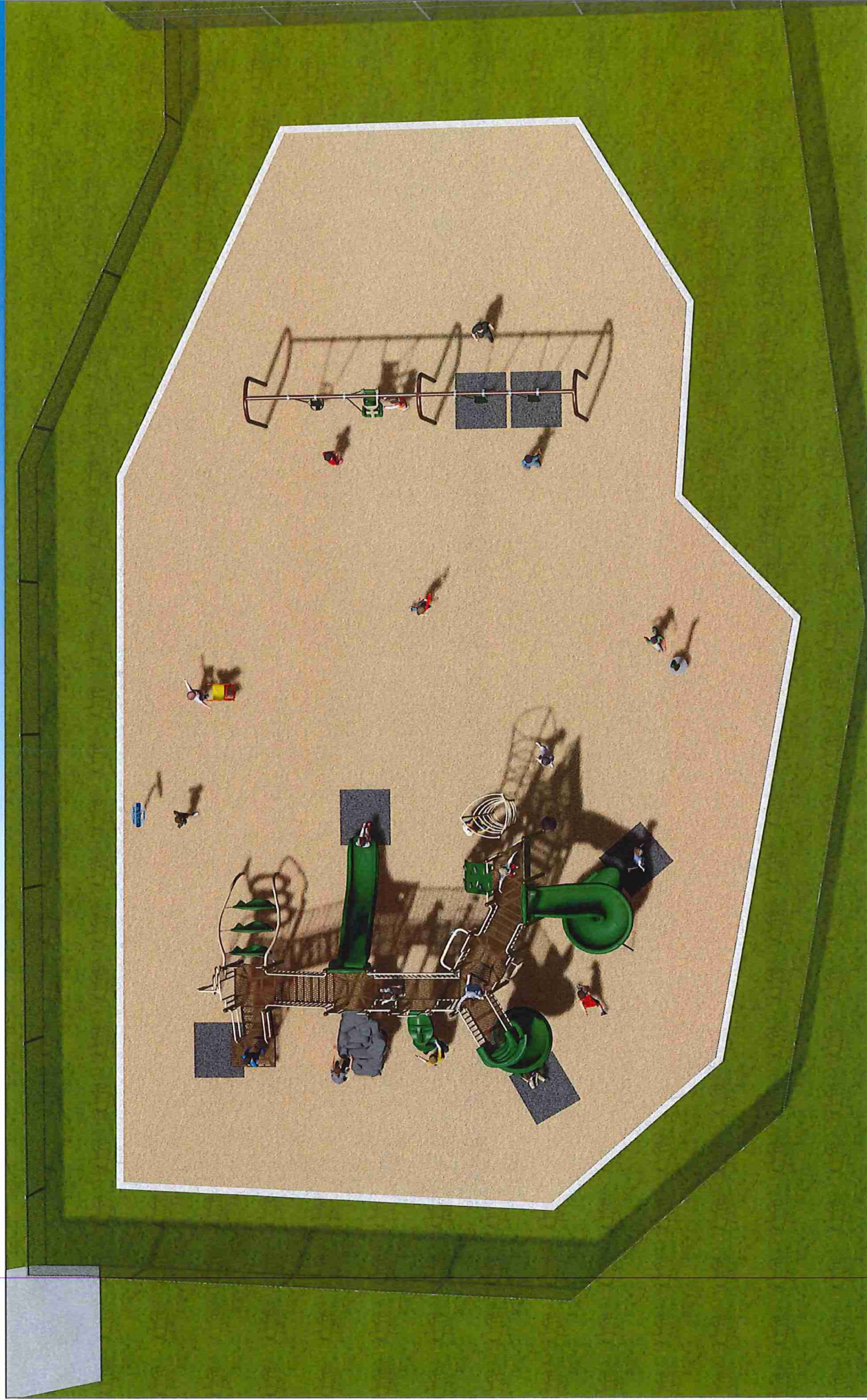

Ashley's Playground - Braun Park

Cloquet, Minnesota



MINNESOTA • WISCONSIN
PLAYGROUND

Plan D10498T





P.O. Box 27328 | Golden Valley, MN 55427
1-800-622-5425 | 763-546-7787 | (F) 763-546-5050
info@mnwiplay.com | www.mnwiplay.com

COLORS OPTION #2

UPRIGHTS: BUTTERSCOTCH

DECKS: GREY

PLASTIC: DARK BLUE

ACCENT METAL: WHITE

HDPE: BLUE & BEIGE

Ashley's Playground - Braun Park

Cloquet, Minnesota



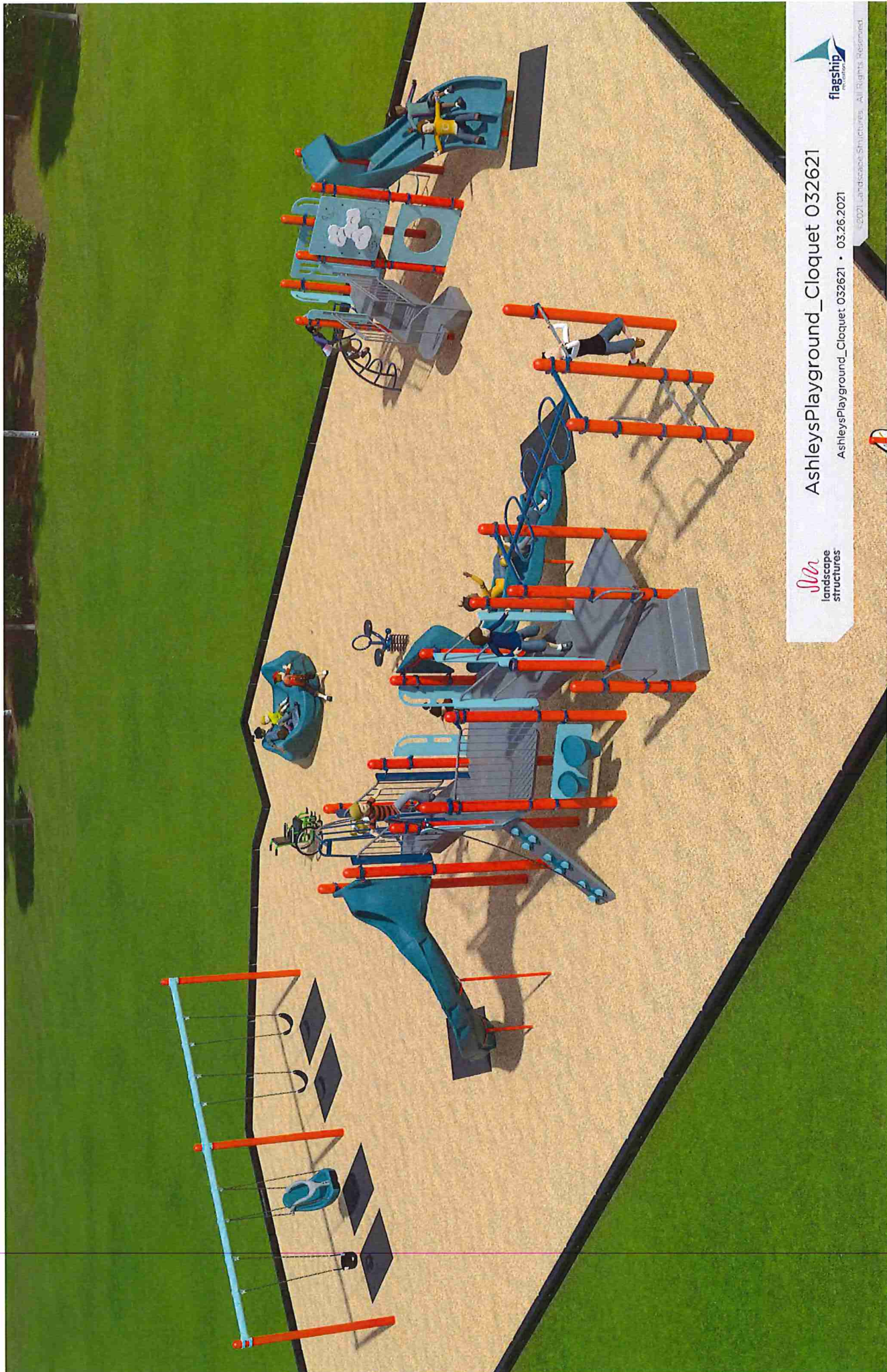

AshleysPlayground_Cloquet 032621

AshleysPlayground_Cloquet 032621 • 03.26.2021



©2021 Landscapes Structures. All Rights Reserved

Date 3/26/2021
 Expires 6/24/2021
 Quote: City of Cloquet
 Contact: Karin Stedman
 Phone: 218-879-6758
 Email: kstedman@cloquetmn.gov



Ship To: Braun Park / Ashley's Playground 14th St & Lawrence Road Cloquet, MN 55720	Please Make PO's & Contracts Out To: Flagship Recreation 11123 Upper 33rd St. N Lake Elmo, MN 55042
Bill To: City of Cloquet 101 14th St Cloquet, MN 55720	Please Remit Payment To: Flagship Recreation 11123 Upper 33rd St. N Lake Elmo, MN 55042

We are pleased to submit this proposal to supply the following products/services:

QTY	ITEM #	Description		
		Ashley's Playground - Braun Park, Cloquet - Mar 26, 2021		
		Booster Basics Design #6467 (5-12 Yr) & Design #292 (2-5 Yr)	List Price	\$43,905.00
		Manufacturer's Program Pricing - Valid 2021 Only - Reduced		(\$13,055.00)
		Freestanding Equipment - Bobble Rider, Omnispin Spinner, Swings	List Price	\$13,505.00
		Flagship Recreation Discount	Discount 15%	(\$1,756.00)
		Playground Equipment ONLY		
		Flagship Recreation Equipment Installation Supervisor (3-Days)	\$3,000.00	No Charge
		Provide Guidance/Support Community/Owner Installation		
		Supervise Layout, Setting Post Heights, Assembly, etc.		
		Owner to provide Volunteers & Equip (Bobcat/Skidsteer, Auger, etc.)		
248	Linear Feet	Commercial Grade Composite Plastic Border w/ ADA Ramp	\$2,776.00	
		Materials Only - Delivered		
7		Rubber Wear Mats - Commercial Grade - Playground		\$1,629.59
		Material Only - No Install Labor		
			Subtotal	\$44,228.59
			Freight	\$500.00
			Sales Tax	Tax Exempt Cert
			Total	\$44,728.59

Quotes from Flagship Recreation, Inc. are subject to current Flagship Recreation, Inc. policies as well as Terms & Conditions, Inclusions & Exclusions outlined below unless noted otherwise on this quote. Changes are subject to price adjustment. Sales tax, if applicable, will be applied unless a tax-exempt certificate is provided at the time of order entry. Customer deposits, if required, must be received before orders will be entered & installation scheduled. Purchases in excess of \$1,000.00 must be supported by a formal Purchase Order made out to Flagship Recreation, Inc.

Minnesota State Contract #119795

***Terms: Net 30 days; 1.5% finance charge on balances over 30 days**

Terms & Conditions

Contract: Seller's Copy of signed quote represents the contract between Seller and Buyer. This form supersedes all previous communications and negotiations and constitutes the entire agreement between the parties. Any changes to this contract are not binding unless jointly agreed in writing via Change Order.

Quantity: The quantity of merchandise and/or material to be delivered and/or installed shall not vary from the amount specified unless a different amount is first agreed to via Change Order. Changes are subject to price adjustment.

Pricing: Pricing is F.O.B factory. Current year pricing is honored on contracts completed prior to December 3, 2020. Contracts completed after this date are subject to price change.

Responsibility: Flagship Recreation shall be responsible for any loss or damage to merchandise until delivered to Buyer at F.O.B destination point. Buyer is responsible for loss or damage thereafter.

Inspection: Merchandise shall be subject to Buyer's inspection within a reasonable time after the arrival at the ultimate destination. Upon inspection, it is the Buyer's responsibility to notify Flagship Recreation if merchandise does not meet requirements of the order.

Project Scope *(This Section For Quotes Including Installation)*

Inclusions:

- One Mobilization
- Public Utility Locates
- Unpacking of Play Equipment
- Assembly of Play Equipment
- Placing, Digging or Surface Mounting Equipment (as specified)
- Concrete for Play Equipment Footings
- Standard Insurance Offer (Detail Provided Upon Request)
- Standard Warranty Offer (Detail Provided Upon Request)
- Standard Wage Rates

Exclusions (Unless Specifically Quoted):

- Accepting & Unloading of Order Prior to Installation
- Storage or Security of Equipment
- Private Utility Locates (irrigation, low voltage, lighting, etc.)
- Additional Labor Due to Site Access. Require 8' Wide Clearance from Staging Area to Play Space.
- Additional Labor and/or Related Costs Due to Subsurface Conditions (Rock, Hardpan, Heavy Clay, Ground Water, etc.)
- Additional Labor and/or Related Costs Due to Working in Unstable Soils (Sand, Pea Rock, Mud, Poor Site Drainage, etc.)
- Offsite Removal of Spoils From Footing Holes or Other Excavation. Can be stockpiled for owner removal or left in play space
- Disposal of Packing Material. Can be Stockpiled for Owner Removal or Deposited in Owners Onsite Dumpster
- Removal of Existing Play Equipment, Border or Safety Surfacing Material
- Site Work of Any Kind. Exclusions include, site grading (owner to provide max slope of 1%), site restoration, drainage, etc.
- Border for Play Space
- Bonding of Any Type
- Permits of Any Kind

Please note, quotes including installation are based on site access and site conditions that have been conveyed to Flagship Recreation by the owner/owner's representative and based on ideal conditions required to complete the project as quoted. Unless addressed prior to the installation quote being issued or specifically documented herein, any issues encountered that impede the progress or completion of the project as quoted will result in additional charges.

Acceptance of Quotation:

Accepted By (Print) Karin Stedman	PO#:
Signature:	Email: kstedman@cloquetmn.gov
Title:	Phone:
Date:	Purchase Amount: \$44,728.59





LSL
landscape
structures

AshleysPlayground_Cloquet 032621

AshleysPlayground_Cloquet 032621 • 03.26.2021

flagship
LANDSCAPE

©2021 Landscape Structures. All Rights Reserved.

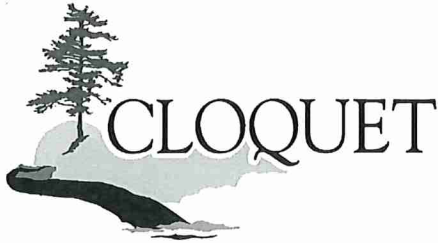

DEPARTMENT OF PUBLIC WORKS

101 14th Street; Cloquet, MN 55720
Phone: (218) 879-6758 Fax: (218) 879-6555
Street - Water - Sewer – Engineering - Park
www.cloquetmn.gov

REQUEST FOR ACTION

To: Park Commission
From: Caleb Peterson, Public Works Director
Date: April 5, 2021

ITEM DESCRIPTION: Cloquet Educational Foundation Fee Waiver.

Proposed Action

Staff recommends the Park Commission **DENY THE CLOQUET EDUCATIONAL FOUNDATION FEE WAIVER REQUEST ON THE GROUND OF PAST PRACTICE FOR SIMILAR EVENTS.**

Background

Staff received a request from the Cloquet Educational Foundation (CEF) to waive the park reservation fee for Dunlap Island for a 9/13/21 event honoring retired District staff. CEF is a nonprofit however this request is atypical of past fee waivers. The event does fall on a weekday and is unlikely to result in lost rental revenue from other users. That said, the event is not tied to any City programming or recreational programming for the public.

Policy Objectives

N/A.

Financial/Budget/Grant Considerations

Potential impacts include loss of \$100 in rental revenue and an hour or two of staff time for facility clean-up and security deposit inspection.

Supporting Documents Attached

Fee Waiver Request.



March 12, 2021

Caleb Peterson
Director of Public Works/City of Cloquet
101 14th Street
Cloquet, MN 55720

To: Caleb Peterson
Parks and Recreation Committee
From: Jody Acers, Executive Director, Cloquet Educational Foundation

Re: Fee Waiver request, Retiree Coffee, 9/13/2021

On September 13, 2021 the Cloquet Educational Foundation (Non Profit EIN #41-1543092) will be using the facilities on Dunlap Island to honor the retired staff of the Cloquet School District. This long-standing tradition -17 years- brings together retired educators, staff and administration for a morning of conversation and and treats. It is a great opportunity to recongnise the important contribution these individuals have given to our children and community.

Would the Cloquet Parks and Rec Committee consider waiving the \$100 fee to rent the facilities on Dunlap Island for the moring of September 13, 2021?

Thank you for your kind consideration. I look forward to hearing from you, and am available for any additional information you might need.

Warmly,

Jody Acers
Executive Director, CEF
jacers@isd94.org
(218) 879-3806

The Cloquet Educational Foundation provides opportunities for academic, artistic, athletic, cultural, and social growth for children and youth in the Cloquet school district by financially supporting programs and activities.

www.cloquetedfoundation.org • 302 14th Street, Cloquet, MN 55720 • (218) 879-3806